



**Integrated Assessment of Agriculture and  
Sustainable Development;  
Setting the Agenda for Science and Policy  
(AgSAP 2009)**

**10 – 12 March 2009  
Hotel Zuiderduin, Egmond aan Zee  
The Netherlands**

**PROGRAMME**

**AgSAP Conference 2009**  
**Egmond aan Zee**  
**The Netherlands**

Local Organizing Committee

Martin van Ittersum	Coordinator SEAMLESS, Wageningen University, Plant Production Systems (NL)
Floor Brouwer	LEI, Wageningen UR (NL)
Joost Wolf	Wageningen University, Plant Production Systems (NL)
Theo Jetten	Wageningen University, C.T. de Wit Graduate School PE&RC (NL)
Marcel Lubbers	Wageningen University, Plant Production Systems (NL)
Charlotte Schilt	Wageningen University, Plant Production Systems (NL)

Corresponding address:

AgSAP Office  
Plant Production Systems  
Wageningen University  
P.O. Box 430, 6700 AK Wageningen  
The Netherlands  
Website: [www.conference-AgSAP.org](http://www.conference-AgSAP.org)  
E-mail: [office.PP@wur.nl](mailto:office.PP@wur.nl)

Printing: GVO drukkers en vormgevers B.V. | Ponsen & Looijen, Ede, The Netherlands

Publisher: Wageningen University and Research Centre, The Netherlands

## Preface

The conference programme is designed around the general theme of “Integrated Assessment of Agriculture and Sustainable Development”. There will be plenary sessions, a concluding forum discussion, and four sub-themes with seventeen parallel sessions, namely:

- A. Methodology for integrated assessment
- B. State-of-the-art components for integrated systems
- C. Case studies and application of tools and empirical methods
- D. Integrated assessment: science and impact

The conference opens with a plenary session, to define the context: developments in agriculture, the relationship with sustainable development, policy questions and the role of science. Research will receive more attention in the second plenary session on the second day. There has been keen interest in the parallel sessions with more than 200 contributions that promise an excellent mix of overview, new methodologies, applications and defining new questions in the sessions on all three days of the conference.

All participants are invited to provide their input to the concluding session of the Conference, the Forum on the final day. This session will focus on the subtitle of AgSAP: “Setting the Agenda for Science and Policy”, and will make use of conclusions from all sessions. And, finally, the poster awards will be announced!

The conference was initiated by the SEAMLESS integrated project (System for Environmental and Agricultural Modelling; Linking European Science and Society), funded by the European Commission under Framework Programme 6. This project (2005-2009; [www.seamless-ip.org](http://www.seamless-ip.org)) developed an operational modelling framework for integrated assessment of agricultural systems. The conference was endorsed by the European Society for Agronomy (ESA), European Federation for Information Technology in Agriculture (EFITA), International Consortium for Agricultural Systems Applications (ICASA) and the International Environmental Modelling and Software Society (iEMSs).

The conference is greatly indebted to the session chairs for organizing the parallel sessions:

- Erling Andersen, University of Copenhagen, Denmark
- John Antle, Montana State University, USA
- Robert Argent, Bureau of Meteorology, Canberra, Australia
- Daniel Auclair, INRA, Montpellier, France
- Martin Banse, LEI, Wageningen UR, The Netherlands
- Irina Bezlepkina, LEI, Wageningen UR, The Netherlands
- Floor Brouwer, LEI, Wageningen UR, The Netherlands
- Frank Ewert, University of Bonn, Germany
- Guillermo Flichman, IAMM, Montpellier, France
- Hayo Haanstra, Ministry of Agriculture, Nature and Food Quality, The Netherlands
- Jim Hansen, International Research Institute for Climate Prediction, New York, USA
- Thomas Heckeley, University of Bonn, Germany
- Katharina Helming, ZALF, Müncheberg, Germany
- Sylvia Herrmann, Leibniz University, Hannover, Germany
- George Hutchinson, Queen's University Belfast, Northern Ireland
- Jim Jones, University of Florida, Gainesville, USA
- Haluk Kasnakoglu, Middle East Technical University, Ankara, Turkey
- Brian Keating, CSIRO, Sustainable Ecosystems, Brisbane, Australia
- Marijke Kuiper, LEI, Wageningen UR, The Netherlands

- Ken Moore, Iowa State University, USA
- Roger Moore, CEH, Wallingford, UK
- Johanna Alkan Olsson, Lund University, Sweden
- Lennart Olsson, Lund University, Sweden
- Maria Luisa Paracchini, Joint Research Centre, Ispra, Italy
- Pytrik Reidsma, Wageningen University, The Netherlands
- Andrea Rizzoli, IDSIA, Lugano, Switzerland
- Mike Robertson, CSIRO, Sustainable Ecosystems, Australia
- Graham Russell, University of Edinburgh, UK
- Stefan Sieber, IPTS, Joint Research Centre, Seville, Spain and ZALF, Germany
- Insa Theesfeld, Leibniz Inst. of Agric. Development in CE Europe, Halle, Germany
- Pablo Tittonell, CIRAD, Montpellier, France
- Nadine Turpin, CEMAGREF, Clermont Ferrand, France
- Elske van de Fliert, The University of Queensland, Brisbane, Australia
- Martin Volk, Helmholtz Centre for Environmental Research - UFZ, Leipzig, Germany
- Jacques Wery, UMR System (Agro.M-CIRAD-INRA), Montpellier, France
- Jan Erik Wien, Alterra, Wageningen UR, The Netherlands

This programme booklet has been designed and prepared by Charlotte Schilt. Thank you, Charlotte for letting the conference benefit from your dedication and skills.

On behalf of the Organization,

Martin van Ittersum and Floor Brouwer

## **Contents**

Programme	1
Overview of room numbers for parallel sessions	4
Detailed programme	5
Information for presenters	28
Posters and demos	29
Travel information	37
Canal boat trip	40
Conference organization and supporting societies	41
Room plans	43



9 <sup>th</sup> Tuesday, March 10 <sup>th</sup>	From 16:00	<b>Registration</b>					
		Van Speykzaal					
	19:00-22.00	<b>Get together</b>					
		<b>Zuiderduinzaal</b>					
	Slot 1 9:00-10:15	<b>Plenary - opening and keynotes</b>					
		M. Kropff (Rector Wageningen University) - Opening address and Welcome G. Verburg (Minister of Agriculture, Nature and Food Quality of The Netherlands) - Agriculture and sustainable development in the Netherlands W. Legg (OECD) - Agriculture and sustainable development in OECD countries: a policy perspective Coffee break					
		<b>Zuiderduinzaal</b>					
	Slot 2 10:45-12:30	<b>Plenary - keynotes</b>					
		J. Von Braun (Int. Food Policy Research Institute) - Agriculture and sustainable development in developing countries T. Haniotis (EC, DG AGRI) - Broadening the knowledge base of policies for sustainability: experience with the IA of recent CAP reforms M. van Ittersum (Wageningen University) - Integrated assessment of agricultural systems: on integrated science and science integration Lunch break					
	Slot 3 13:45-15:30	<b>Room 558</b> Session A3: Integrated assessment of ecosystem services from agriculture Chairs: F. Brouwer, G. Hutchinson Keynote: A. Buckwell	<b>Room 559</b> Session B2: Indicators for integrated assessment of agricultural systems and land use Chairs: M.L. Paracchini, N. Turpin Keynote: C. Binder	<b>Room 530</b> Session A1: Methods for integrated assessment of agricultural systems and land use Chairs: I. Bezlepina, S. Sieber Keynote: K. Helming	<b>Room 531</b> Session A2: Methods for up- and down-scaling in integrated assessments Chairs: F. Ewert, M. Volk Keynote: J. Antle	<b>Room 532</b> Session B6: Software infrastructures and tools for integrated assessments Chairs: R. Argent, A. Rizzoli, J.E. Wien, Keynote: R. Moore	<b>Room 533</b> Session B7: Databases for integrated assessment of agriculture and rural development Chairs: E. Andersen, H. Kasnakoglu Keynote: H. Kasnakoglu
Slot 4 16:00-17:00	<b>Foyer and Le Regal (entrance Zuiderduinzaal)</b>						
	<b>Poster (A1-B4) and Demo (all) tour</b>						
Slot 5 17:00-18:45	<b>Room 558</b> Session A3: Continued	<b>Room 559</b> Session B3: Cropping system modelling Chairs: J. Jones, M. Robertson, G. Russell Keynote: B. Keating	<b>Room 530</b> Session A1: Continued	<b>Room 531</b> Session A2: Continued	<b>Room 532</b> Session B6: Continued	<b>Room 533</b> Session B4: Bio-economic farm Chairs: G. Flichman, P. Reidsma Keynote: G. Flichman	
Evening 19:15-23:00	<b>Zuiderduinzaal</b>						
	<b>Conference Dinner</b>						

Zuiderduinzaal					
<b>Plenary - keynotes</b>					
J. Rotmans (Erasmus Univ., Rotterdam) - Two decades of integrated assessment tools: a promising way forward P. Pingali (Bill & Melinda Gates Foundation) - Enhancing developing world agricultural performance: getting beyond the current plateau					
Coffee break					
<b>Slot 6</b> <b>8:45-10:00</b>	<b>Room 558</b> Session A3: Continued	<b>Room 559</b> Session B3: Continued	<b>Room 530</b> Session A4: The organization of tools for integrated assessment – standards or diversity? Chairs: K. Helming, R. Moore Keynote: P. de Smedt	<b>Room 531</b> Session B1: Large scale integrated policy assessment: tools and applications Chair: T. Heckelei Keynote: T. Hertel	<b>Room 532</b> Session B5: Integrated assessment methods for regional and landscape levels Chairs: J. Antle, D. Auclair Keynote: J. Stoorvogel
<b>Slot 7</b> <b>10:30-12:15</b>					<b>Room 533</b> Session B4: Continued
<b>Foyer and Le Regal (entrance Zuiderduinzaal)</b>					
<b>Slot 8</b> <b>12:15-13:45</b>	<b>Lunch - Poster (B5-D2) and Demo (all) tour</b>				
<b>Slot 9</b> <b>13:45-15:30</b>	<b>Room 558</b> Session C1: Integrated assessment of biomass for biofuel or renewables - trade-offs with feed and food Chairs: M. Banse, K. Moore Keynote: J.E. Petersen	<b>Room 559</b> Session B3: Continued	<b>Room 530</b> No session scheduled	<b>Room 531</b> Session B1: Continued	<b>Room 532</b> Session B5: Continued
Coffee and snack break					
<b>16:00-22:00</b>	<b>Social event</b>				

Wednesday, March 11<sup>th</sup>



Thursday, March 12 <sup>th</sup>						
<b>Slot 10</b> 9:00-10:45	<b>Room 558</b>	<b>Room 559</b>	<b>Room 530</b>	<b>Room 531</b>	<b>Room 532</b>	<b>Room 533</b>
	Session C1: Continued	Session D1: Stakeholder involvement in designing, use and evaluation of integrated assessment models  Chairs: S. Herrmann, J. Alkan-Olsson, E. Van de Fliert Keynote: C. Pahl-Wostl	Session C2: Modelling adaptation strategies to cope with climate change  Chairs: J. Hansen, L. Olsson Keynote: H. Meinke	Session C3: Application of integrated assessment tools  Chairs: M. Kuiper, J. Wery Keynote: J. Wery	Session C4: Systems analysis informing policy – case studies from agricultural systems and rural regions in the face of change  Chairs: B. Keating, P. Tittonell Keynote: D. Pannell	Session D2: Role of integrated assessment for policy making and evaluation  Chairs: F. Brouwer, H. Haanstra, I. Theesfeld
Coffee break						
<b>Slot 11</b> 11:15-13:00	<b>Room 558</b>	<b>Room 559</b>	<b>Room 530</b>	<b>Room 531</b>	<b>Room 532</b>	<b>Room 533</b>
	Session C1: Continued	Session D1: Continued	Session C2: Continued	Session C3: Continued	Session C4: Continued	Session D2: Continued
Lunch						
<b>Zuiderduinzaal</b>						
<b>Slot 12</b> 14:00-15:30	<b>AgSAP poster award</b>					
	<p style="text-align: center;"><b>Forum discussion to:</b></p> <ul style="list-style-type: none"> <li>- Present the key scientific achievements from the conference</li> <li>- Identify the scientific challenges ahead</li> <li>- Identify policy advice for impact assessment of agriculture and sustainable development, and</li> <li>- Strengthen science-policy interactions in agriculture and sustainable development</li> </ul>					
Closing						
<b>Pub</b>						
<b>15:30-16:00</b>	<b>Farewell drinks</b>					

## Overview room numbers for parallel sessions

Tuesday, March 10						
<b>Room no.</b>	558	559	530	531	532	533
<b>Start time</b>						
13:45	A3	B2	A1	A2	B6	B7
17:00	A3	B3	A1	A2	B6	B4
Wednesday, March 11						
<b>Room no.</b>	558	559	530	531	532	533
<b>Start time</b>						
10:30	A3	B3	A4	B1	B5	B4
13:45	C1	B3	-	B1	B5	B4
Thursday, March 12						
<b>Room no.</b>	558	559	530	531	532	533
<b>Start time</b>						
9:00	C1	D1	C2	C3	C4	D2
11:15	C1	D1	C2	C3	C4	D2

Rooms 558 and 559 are located at the ground floor (Etage 0)

Rooms 530, 531, 532, 533 are on the first floor (Etage 1)

**Slot 1: Tuesday 9:00-10:15**

**Zuiderduinzaal**

**Opening and keynote session**

Chair: Martin Kropff (Rector Wageningen University)

**Keynotes:**

Martin Kropff - Opening address and Welcome

Gerda Verburg (Minister of Agriculture, Nature and Food Quality of The Netherlands) - Agriculture and sustainable development in the Netherlands

Wilfrid Legg (OECD) - Agriculture and sustainable development in OECD countries: a policy perspective

**Slot 2: Tuesday 10:45-12:30**

**Zuiderduinzaal**

**Keynote session**

Chair: Martin Kropff

**Keynotes:**

Joachim Von Braun (Int. Food Policy Research Institute) - Agriculture and sustainable development in developing countries

Tassos Haniotis (EC, DG AGR1) - Broadening the knowledge base of policies for sustainability: experience with the IA of recent CAP reforms

Martin van Ittersum (Wageningen University) - Integrated assessment of agricultural systems: on integrated science and science integration

**Slot 3: Tuesday 13:45-15:30**

<b>Room 558</b>		<b>Room 559</b>	
<b>Time</b>	<b>Session A3-1: Integrated assessment of ecosystem services from agriculture</b> Chairs: Floor Brouwer, George Hutchinson	<b>Time</b>	<b>Session B2-1: Indicators for integrated assessment</b> Chairs: Maria Luisa Paracchini, Nadine Turpin
<b>13:45</b>	Environmental services delivered and deliverable by land managers Allan Buckwell	<b>13:45</b>	Sustainability Solution Space: an indicator based tool for assessing the sustainability of agricultural systems Claudia Binder
<b>14:10</b>	Examining the degree of jointness between food and cultural landscape production Erling Vårdal & David Blandford	<b>14:10</b>	A structured set of indicators for integrated assessment of future agri- environmental policies Christian Bockstaller
<b>14:30</b>	Policy options for safeguarding the provision of public goods and services in intensive and extensive farming systems Henk Westhoek	<b>14:30</b>	Rural regions in Europe - A new typology based on a multi-sectoral point of view Johanna Scholz
<b>14:50</b>	Analysing, forecasting and valuating the effects of landscape change on the ecosystem service of biological pest control Wopke van der Werf	<b>14:50</b>	Agri-environmental nitrogen indicators for EU27 Adrian Leip
<b>15:10</b>	Posters	<b>15:10</b>	Posters & Discussion
<b>15:20</b>	Discussion		

**Slot 3: Tuesday 13:45-15:30**

<b>Room 530</b>		<b>Room 531</b>	
<b>Time</b>	<b>Session A1-1: Methods for integrated assessment of agricultural systems and land use</b> Chairs: Irina Bezlepkina, Stefan Sieber	<b>Time</b>	<b>Session A2-1: Methods for up- and down-scaling in integrated assessments</b> Chairs: Frank Ewert, Martin Volk
<b>13:45</b>	Scenario studies for agriculture, land use and landscape in Europe – a comparison Katharina Helming	<b>13:45</b>	Strategies for addressing spatial and temporal scale in integrated assessment of agricultural systems John Antle
<b>14:10</b>	The CAPRI and GTAP - link: Linking a partial and a global equilibrium model Marcel Adenauer	<b>14:10</b>	EU-wide spatial down-scaling of results of a regionalised agricultural economic model to analyse environmental impacts Wolfgang Britz
<b>14:30</b>	An integrated assessment of global changes in crop-livestock systems to 2030: implications for policy development Mario Herrero	<b>14:30</b>	Coupling integrated assessment models to market equilibrium models to analyze economic and agricultural-environment interactions across different scales Roberto Valdivia
<b>14:50</b>	The LUMOCAP PSS, impact assessment of agricultural policies in an integrative context Hedwig van Delden & Maria Luisa Paracchini	<b>14:50</b>	Effect of spatial resolution within the Cross Compliance assessment tool - the case of Nitrate Directive Jaap van Os
<b>15:10</b>	Posters	<b>15:10</b>	Posters
<b>15:20</b>	Discussion		

**Slot 3: Tuesday 13:45-15:30**

<b>Room 532</b>		<b>Room 533</b>	
<b>Time</b>	<b>Session B6-1: Software infrastructures and tools for integrated assessments</b> Chairs: Robert Argent, Andrea Rizzoli, Jan Erik Wien	<b>Time</b>	<b>Session B7-1: Databases for integrated assessment of agriculture and rural development</b> Chairs: Erling Andersen, Haluk Kasnakoglu
<b>13:45</b>	Integrated modelling tools, mass collaboration and the opportunities ahead Roger Moore	<b>13:45</b>	Usefulness, feasibility, limitations and sustainability of an integrated international database on agricultural statistics Haluk Kasnakoglu
<b>14:10</b>	Granular ontologies for integrated assessment of agricultural systems Ioannis Athanisiadis	<b>14:05</b>	The need for a theoretical background in building an integrated database Xavier Arnauld de Sartre
<b>14:30</b>	Support tool for the overall assessment of animal welfare Raphaelle Botreau	<b>14:20</b>	Integrating farming system, environmental and socioeconomic data - The SEAMLESS database Erling Andersen
<b>14:50</b>	What are the key factors for successful integration of life cycle assessment into FADN? Thomas Nemecek	<b>14:35</b>	Some reflections on the design and use of typologies of EU regions in socio-economic analyses Ida Terluin
<b>15:10</b>	Posters & Discussion	<b>14:50</b>	European environmental stratifications: an overview Gerard Hazeu
		<b>15:05</b>	Detailed spatial distribution of farming systems in Europe: A basic starting point for the further environmental assessment of changes in farming and CAP reform Markus Kempen
		<b>15:20</b>	Discussion

**Slot 4: Tuesday 16:00-17:00**

**Foyer and Le Regal (entrance Zuiderduinzaal)**

# **Poster tour**

Sessions

**A1, A2, A3, A4**

**B1, B2, B3, B4**

**and all 4 Demo contributions**

Poster visits led by the session chairs

For details on the poster and demo contributions see pages 29-35

**Slot 5: Tuesday 17:00-18:45**

<b>Room 558</b>		<b>Room 559</b>	
<b>Time</b>	<b>Session A3-2: Integrated assessment of ecosystem services from agriculture</b> Chairs: Floor Brouwer, George Hutchinson	<b>Time</b>	<b>Session B3-1: Cropping system modelling</b> Chairs: Jim Jones, Michael Robertson, Graham Russell
<b>17:00</b>	Valuation of ecosystem services and decision making: combining a CBA with MCA Martijn van der Heide	<b>17:00</b>	Cropping systems modelling: Past performance and future prospects Brian Keating
<b>17:20</b>	Redefining landscape economics: a proposal to integrate economics approaches and landscape disciplines Carolina Tagliaferro	<b>17:25</b>	APES: The Agricultural Production and Externalities Simulator Marcello Donatelli & Graham Russell
<b>17:40</b>	How do policy options modify landscape amenities? An assessment approach based on public expressed preferences Teresa Pinto-Correia	<b>17:45</b>	The interaction between sub-optimally available resources for crop production as implemented in the simplified model FIELD Pablo Tittonell
<b>18:00</b>	Regional sustainability contrasts in Brazil as indicated by the CompasSus - Compass of Sustainability Saulo Rodrigues-Filho	<b>18:05</b>	Toward gene based crop simulation models for use in climate change studies Stephen Welch
<b>18:20</b>	Posters	<b>18:25</b>	Posters & Discussion
<b>18:30</b>	Discussion		



**Slot 5: Tuesday 17:00-18:45**

<b>Room 530</b>		<b>Room 531</b>	
<b>Time</b>	<b>Session A1-2: Methods for integrated assessment of agricultural systems and land use</b> Chairs: Irina Bezlepkina, Stefan Sieber	<b>Time</b>	<b>Session A2-2: Methods for up- and down-scaling in integrated assessments</b> Chairs: Frank Ewert, Martin Volk
<b>17:00</b>	Integrated assessment of nutrient management options in smallholder farming systems - the NUANCES framework Pablo Tittonell & Ken Giller	<b>17:00</b>	Complex scaling issues in integrated assessment modelling - approaches used and their integration into SEAMLESS-IF Frank Ewert
<b>17:20</b>	Modelling resource distribution in mountainous watersheds in Thailand: an integrated approach Carsten Marohn	<b>17:20</b>	EXPAMOD - connecting the farm and market levels Ignacio Pérez-Dominguez
<b>17:40</b>	Integrating multiple functions to optimise rural land health Dale Watson & Burghard Meyer	<b>17:40</b>	Spatial upscaling of on-farm indicators: concepts to use a scientific knowledge base to match policymakers' requirements Nadine Turpin
<b>18:00</b>	Integration of interdisciplinary participative research tools: New vistas for land use modelling? Melvin Lippe	<b>18:00</b>	Farm typology identification by multivariate analysis as a method to scale-up results of integrated impact assessment Emilio Righi
<b>18:20</b>	Posters	<b>18:20</b>	Posters
<b>18:25</b>	Discussion	<b>18:30</b>	Discussion

**Slot 5: Tuesday 17:00-18:45**

<b>Room 532</b>		<b>Room 533</b>	
<b>Time</b>	<b>Session B6-2: Software infrastructures and tools for integrated assessments</b> Chairs: Robert Argent, Andrea Rizzoli, Jan Erik Wien	<b>Time</b>	<b>Session B4-1: Bio-economic farm modelling</b> Chair: Guillermo Flichman, Pytrik Reidsma
<b>17:00</b>	The role of the Object Modelling System (OMS) for integrated assessments of conservation on agricultural land in the United States Jack Carlson	<b>17:00</b>	Some conceptual issues for modelling the interaction between agriculture and environment through the bio-economic mathematical programming models Guillermo Flichman
<b>17:20</b>	Architecture of SEAMLESS-IF as framework application for integrated modelling Jan Erik Wien	<b>17:25</b>	An appraisal of risk on perennial energy crops in France Géraldine Bocquého
<b>17:40</b>	Tools for transparent spatial integrated assessments Peter Verweij	<b>17:45</b>	Farming Systems Simulator: first generic bio-economic farm model Sander Janssen
<b>18:00</b>	Parameter estimation software for crop models Daniel Wallach	<b>18:05</b>	Dynamics of suckler cow farms under stochastic crop yields: A recursive discrete stochastic programming approach Claire Mosnier
<b>18:20</b>	Posters, Demos & Discussion	<b>18:25</b>	Posters
		<b>18:35</b>	Discussion

**Slot 6: Wednesday 8:45-10:00**

**Zuiderduinzaal**

**Keynote session**

Jan Rotmans (Erasmus Univ., Rotterdam) - Two decades of integrated assessment tools – a promising way forward  
Prabhu Pingali (Bill & Melinda Gates Foundation) - Enhancing developing world agricultural performance: getting beyond the current plateau

**Slot 7: Wednesday 10:30-12:15**

<b>Room 558</b>		<b>Room 559</b>	
<b>Time</b>	<b>Session A3-3: Integrated assessment of ecosystem services from agriculture</b> Chairs: Floor Brouwer, George Hutchinson	<b>Time</b>	<b>Session B3-2: Cropping system modelling</b> Chairs: Jim Jones, Michael Robertson, Graham Russell
<b>10:30</b>	Economic modelling of multifunctionality at the farm level Eirik Romstad	<b>10:30</b>	The Soil C&N module of APES: simulating the immobilisation-mineralisation turnover for predicting short- and long-term C and N dynamics in the soil Marc Corbeels
<b>10:50</b>	Land Use Functions: an approach for integrated assessment of the goods and services provided by agriculture in a multi-functional and sustainable context Marta Pérez-Soba	<b>10:50</b>	Uncertainties in simulating cropping system responses in degraded soils and low input production systems Jim Jones
<b>11:10</b>	Predicting combined impacts of land management and pollution on biodiversity: a dynamic niche occupancy approach Edwin Rowe	<b>11:10</b>	Modelling of cover-cropped vineyards with APES: a modular simulation platform Aurelie Metay & Christian Gary
<b>11:30</b>	Posters	<b>11:30</b>	Development of generic management rules for crop growth simulation models Roelof Oomen
<b>12:00</b>	Discussion	<b>11:50</b>	Posters & Discussion

**Slot 7: Wednesday 10:30-12:15**

<b>Room 530</b>		<b>Time</b>	<b>Room 531</b>
<b>Time</b>	<b>Session A4-1: The organization of tools for integrated assessment – standards or diversity?</b> Chairs: Katharina Helming, Roger Moore		<b>Session B1-1: Large scale integrated policy assessment: tools and applications</b> Chair: Thomas Heckelei
<b>10:30</b>	Impact assessment practice to support sustainable policy measures in Europe Peter de Smedt	<b>10:30</b>	Impacts of EU Biofuels Directives on global markets and EU environmental quality: An integrated PE, Global CGE analysis Thomas Hertel & Wolfgang Britz
<b>10:55</b>	Swiss Agricultural Life Cycle Assessment (SALCA): An integrated environmental assessment concept for agriculture Gerard Gaillard	<b>10:55</b>	The impact of modulation; modelling first and second pillar CAP policies Hans van Meijl
<b>11:15</b>	A methodology for enhanced flexibility of integrated assessment of policy impacts in agriculture Frank Ewert & Olivier Therond	<b>11:15</b>	What if not all land is created equal? The role of heterogeneous land when assessing the impact of trade liberalization on developing countries Marijke Kuiper
<b>11:35</b>	A methodological framework for sustainability impact assessment of land use policies in developing countries: re-using and complementing approaches Pytrik Reidsma	<b>11:35</b>	Integrated economic - environmental modelling for domestic policy development and assessment: the Canadian experience Hugues Morand
<b>11:55</b>	Posters	<b>11:55</b>	Farm structural change in European regions Andrea Zimmermann
<b>12:05</b>	Discussion		

**Slot 7: Wednesday 10:30-12:15**

<b>Room 532</b>		<b>Room 533</b>
<b>Time</b>	<b>Session B5-1: Integrated assessment methods for regional and landscape levels</b> Chairs: John Antle, Daniel Auclair	<b>Session B4-2 Bio-economic farm modelling</b> Chair: Guillermo Flichman, Pytrik Reidsma
<b>10:30</b>	Integrated assessment modelling: how to assess regional impacts? Jetse Stoorvogel	EU dairy farming in the face of change: An exploration using a bio-economic farm model Kamel Loughichi
<b>10:55</b>	An agent-based model for assessing the impacts of decoupled agricultural support on landscape values Mark Brady	Modelling nitrogen balance for a regional scale livestock-pasture system as a discussion support tool Uday Nidumolu
<b>11:15</b>	Assessing and predicting the agro-structural change in the Alpine Region Thomas Streifeneder	Higher prices, less nature management? Modelling farmers' decisions on dairy farms Hans Leneman
<b>11:35</b>	Assessing the institutional compatibility of new policies Christian Schleyer	Posters
<b>11:55</b>	Posters & Discussion	Discussion

**Slot 8: Wednesday 12:15-13.45**

**Foyer and Le Regal**

# **Poster tour**

Sessions

**B5, B6,**

**C1, C2, C3, C4**

**D1 and D2**

**and all 4 Demo contributions**

Poster visits led by the session chairs

For details on the poster and demo contributions see pages 29-35

during lunch buffet

**Slot 9: Wednesday 13:45-15:30**

<b>Room 558</b>		<b>Room 559</b>	
<b>Time</b>	<b>Session C1-1: Integrated assessment of biomass for biofuel or renewables – trade-offs with feed and food</b> Chairs: Martin Banse, Ken Moore	<b>Time</b>	<b>Session B3-3: Cropping system modelling</b> Chairs: Jim Jones, Michael Robertson, Graham Russell
<b>13:45</b>	Challenges in modelling environmental bioenergy potential(s) Jan Erik Petersen	<b>13:45</b>	Crop systems evaluation for strategic investment decisions Jawoo Koo
<b>14:10</b>	Environmental impacts of agricultural land allocation between bioenergy crops and food/feed crops Jussi Lankoski	<b>14:05</b>	Extracting useful information from daily GCM rainfall for cropping system modelling Amor Ines & Jim Hansen
<b>14:30</b>	Exploring the land, water and energy linkages in agriculture: an expanded partial-equilibrium approach to modelling environmental impacts Siwa Msangi	<b>14:25</b>	Spatialising a biodecisional crop-model to assess the sensitivity of a region to modifications in agricultural practices Lucie Clavel
<b>14:50</b>	Biofuels - the way forward Adrian Leip	<b>14:45</b>	Using a cropping system model for large scale impact assessment in Europe Eric Casellas
<b>15:10</b>	Posters & Discussion	<b>15:05</b>	Posters & Discussion



**Slot 9: Wednesday 13:45-15:30**

<b>Room 530</b>		<b>Room 531</b>	
<b>Time</b>	<b>No session scheduled</b>	<b>Time</b>	<b>Session B1-2: Large scale integrated policy assessment: tools and applications</b> Chair: Thomas Heckelei
		<b>13:45</b>	Modelling global N and P surface balances: implementation of the millennium ecosystem assessment scenarios Lex Bouwman
		<b>14:05</b>	The fate of nitrogen in the Brazilian soybean chain Eric Smaling
		<b>14:25</b>	Spatial planning of livestock production and manure abatement Bart van der Straeten
		<b>14:45</b>	Agriculture and natural resources in a changing world - the role of irrigation Timm Sauer
		<b>15:05</b>	Posters & Discussion

**Slot 9: Wednesday 13:45-15:30**

<b>Room 532</b>		<b>Room 533</b>	
<b>Time</b>	<b>Session B5-2: Integrated assessment methods for regional and landscape levels</b> Chairs: John Antle, Daniel Auclair	<b>Time</b>	<b>Session B4-3 Bio-economic farm modelling</b> Chair: Guillermo Flichman, Pytrik Reidsma
<b>13:45</b>	Integration of agriculture, groundwater and economic models using the Open modelling Interface (OpenMI): Application to the Ogallala Aquifer Tom Bulatewicz	<b>13:45</b>	Linking cropping systems models with farm bio-economic models to examine the relationship between profit and natural resource condition Michael Robertson
<b>14:05</b>	Sustainability impact assessment of EU policies at regional level – An analysis of land use dynamics and environmental effects with the MEA-Scope tool Sandra Uthes	<b>14:05</b>	Integration of bio-physical and economic models for spatially explicit land use and landscape analysis on farm level Martin Schönhart & Thomas Schauppenlehner
<b>14:25</b>	How to design technical and organisational innovations to promote sustainable development in catchments with intensive use of pesticides Christian Gary	<b>14:25</b>	Economic analysis of cover crop (white mustard) adoption to reduce take-all disease and N-leaching Gael Goulevant & Arnaud Reynaud
<b>14:45</b>	Generic bio-economic modelling of plant diseases: an exploration Annemarie Breukers	<b>14:45</b>	A whole farm simulation model to improve multi-criteria system efficiency Jonathan Vayssières
<b>15:05</b>	Posters, Demo & Discussion	<b>15:05</b>	Posters
		<b>15:10</b>	Discussion

**Slot 10: Thursday 9:00-10:45**

<b>Room 558</b>		<b>Room 559</b>	
<b>Time</b>	<b>Session C1-2: Integrated assessment of biomass for biofuel or renewables – trade-offs with feed and food</b> Chairs: Martin Banse, Ken Moore	<b>Time</b>	<b>Session D1-1: Stakeholder involvement in designing, use and evaluation of integrated assessment models</b> Chairs: Sylvia Herrmann, Johanna Alkan Olsson, Elske van de Fliert
<b>9:00</b>	First and second generation biofuels up to 2030 - possible scenarios and their environmental impacts Elke Stehfest	<b>9:00</b>	The role of models in supporting processes of change towards sustainable resource governance Claudia Pahl-Wostl
<b>9:20</b>	Application of Life Cycle Assessment methodology to compare sunflower oil and diesel for fulfilling farm energy needs Lucia Coletto	<b>9:25</b>	Agricultural decision support systems: Tools to facilitate co-learning for stakeholders and scientists Peter Thorburn
<b>9:40</b>	Bio-ethanol from sugar beet in the Netherlands: sustainability assessment Gerrie van de Ven	<b>9:45</b>	Prospecting the behaviour of agro-ecosystems: experiences in using FALLOW model with natural resource managers Betha Lusiana
<b>10:00</b>	Greenhouse gas emissions from grassland swards: a Scottish Perspective Kairsty Topp	<b>10:05</b>	Modellers, model results and local stakeholders - dynamics in combining expert and lay knowledge in locally grounded policy formulation Anna Jonsson
<b>10:20</b>	Posters & Discussion	<b>10:25</b>	Posters

**Slot 10: Thursday 9:00-10:45**

<b>Room 530</b>		<b>Room 531</b>	
<b>Time</b>	<b>Session C2-1: Modelling adaptation strategies to cope with climate change</b> Chairs: Jim Hansen, Lennart Olsson	<b>Time</b>	<b>Session C3-1: Application of integrated assessment tools</b> Chairs: Marijke Kuiper, Jacques Wery
<b>09:00</b>	Will global mitigation policy enhance or undermine local adaptation? Holger Meinke	<b>09:00</b>	Application of the SEAMLESS-IF modelling chain for integrated assessment of agricultural systems and policies at regional and global levels Jacques Wery
<b>09:30</b>	Pre-requisites for crop models used to test strategies for adapting to, or mitigating effects of climate change Ken Boote	<b>09:25</b>	A decision support to choose between changes of agricultural practices. A spatially distributed costs/effectiveness assessment framework Jean-Marie Lescot
<b>09:50</b>	Exploring options to improve adaptation to climate change in crop production of Southeastern South America Walter Baethgen	<b>09:45</b>	Integrated impact assessment of agro-environmental schemes on soil erosion and water quality Martina Perugini
<b>10:10</b>	SimKat: a virtual laboratory to explore the impact of climate change scenarios on the Western Australian wheat-belt Anne Dray	<b>10:05</b>	Quantification of the impacts of cross compliance measures on European air, soil and water quality Jan-Peter Lesschen
<b>10:30</b>	Posters & Discussion	<b>10:25</b>	Posters & Discussion

**Slot 10: Thursday 9:00-10:45**

<b>Room 532</b>		<b>Room 533</b>	
<b>Time</b>	<b>Session C4-1: Systems analysis informing policy – case studies from agricultural systems and rural regions in the face of change</b> Chairs: Brian Keating, Pablo Tiftonell	<b>Time</b>	<b>Session D2-1: Role of integrated assessment for policy making and evaluation</b> Chairs: Floor Brouwer, Hayo Haanstra, Insa Theesfeld
<b>09:00</b>	Systems analysis informing policy David Pannell	<b>09:00</b>	A multi-criteria approach to environmental policy Tim Oxley & Nighat Hasnain
<b>09:25</b>	Investigating the economic and water quality effects of the 2003 CAP reform on arable cropping systems: a Scottish case study Ioanna Mouratiadou	<b>09:20</b>	Participatory IA tool development - Lessons learnt in the SEAMLESS project Johanna Alkan-Olsson
<b>09:45</b>	Direct and indirect impacts of CAP changes on the economy of rural areas. Integrated assessment of farm households' adaptation strategies in Eastern and Western Germany Andrej Lange	<b>09:40</b>	Determinants of policy oriented research design Bettina König
<b>10:05</b>	Efficiency of environmental policies in agriculture in the Czech Republic. The case of dairy cattle Martina Havlikova	<b>10:00</b>	Posters
<b>10:25</b>	Posters & Discussion	<b>10:20</b>	Discussion

**Slot 11: Thursday 11:15-13:00**

<b>Room 558</b>		<b>Room 559</b>	
<b>Time</b>	<b>Session C1-3: Integrated assessment of biomass for biofuel or renewables – trade-offs with feed and food</b> Chairs: Martin Banse, Ken Moore	<b>Time</b>	<b>Session D1-2: Stakeholder involvement in designing, use and evaluation of integrated assessment models</b> Chairs: Sylvia Herrmann, Johanna Alkan Olsson, Elske van de Fliert
<b>11:15</b>	Soil optimized suitability analysis for allocation of energy grasses Liia Kukk	<b>11:15</b>	Participatory modelling for renewable resource management - a critical assessment Annemarie van Paassen
<b>11:35</b>	The availability of crop residues for energy, assessing global potentials Thomas Guille	<b>11:30</b>	Accounting for user's uncertainty information needs in integrated assessment models: the case of the SEAMLESS Integrated Framework Silke Gabbert
<b>11:55</b>	Family production systems with dende (Elaeis guineensis) and the alternative of biodiesel: analysis in the Cajaíba community, municipality of Valença, (Bahia-Brazil) Alynson Rocha	<b>11:45</b>	Application of an integrated monitoring tool for sustainable dairy farming in Flanders Karen de Meij
<b>12:15</b>	Energy maize for phytoremediation of metal-enriched soils and production of energy; Case: the Campine region (BE) Stijn van Slycken	<b>12:00</b>	Learning by doing: Designing and conducting impact assessment studies for citrus Farmer Field Schools in Vietnam Oleg Nicetic
<b>12:35</b>	Posters & Discussion	<b>12:15</b>	Models as social learning tools in participatory integrated assessment Joop de Kraker
		<b>12:30</b>	General discussion

**Slot 11: Thursday 11:15-13:00**

<b>Room 530</b>		<b>Room 531</b>	
<b>Time</b>	<b>Session C2-2: Modelling adaptation strategies to cope with climate change</b> Chairs: Jim Hansen, Lennart Olsson	<b>Time</b>	<b>Session C3-2: Application of integrated assessment tools</b> Chairs: Marijke Kuiper, Jacques Wery
<b>11:15</b>	A minimum-data approach to ex ante assessment of climate change adaptation strategies in resource-poor countries Lieven Claesens	<b>11:15</b>	Building crop producers' capacity to adapt to climate change and climate variability with Yield Prophet Zvi Hochman
<b>11:35</b>	Analysis of land use combination to minimize global warming potential from farmland and farmland surplus nitrogen and maximize income using eco-balance analysis Sonoko Kimura	<b>11:35</b>	Assessment of flood prevention contribution of multifunctional agricultural land: results of a case study in Lower Austria Julia Neuwirth
<b>11:55</b>	Assessment of nitrogen and greenhouse gas fluxes at the European scale in response to land use and livestock change Wim de Vries	<b>11:55</b>	Using MASC to evaluate the sustainability of cropping systems: Application to multicriteria assessment of organic cropping systems in Southern France Bruno Colomb & F. Angevin
<b>12:15</b>	GHG mitigation through bioenergy production versus avoided deforestation and afforestation: A quantitative analysis Petr Havlik	<b>12:15</b>	Challenges in the application of multi-criteria assessment (MCA) for the evaluation of irrigation management alternatives: PLEIADeS project Paula Antunes
<b>12:35</b>	Posters & Discussion	<b>12:35</b>	Posters
		<b>12:45</b>	General discussion on Use of Integrated frameworks in ex-ante policy assessments

**Slot 11: Thursday 11:15-13:00**

<b>Room 532</b>		<b>Room 533</b>	
<b>Time</b>	<b>Session C4-2: Systems analysis informing policy – case studies from agricultural systems and rural regions in the face of change</b> Chairs: Brian Keating, Pablo Tittonell	<b>Time</b>	<b>Session D2-2: Role of integrated assessment for policy making and evaluation</b> Chairs: Floor Brouwer, Hayo Haanstra, Insa Theesfeld
<b>11:15</b>	Ex-ante assessment of the abolishment of the EU set aside policy: Results from a bio-economic farm analysis Argyris Kanellopoulos	<b>11:15</b>	Contribution of the development process to the actual implementation and use of integrated spatial decision support Systems Hedwig van Delden
<b>11:35</b>	Assessing poverty-sustainability tradeoffs in semi-subsistence agricultural systems: A case study of policy options in Machakos, Kenya John Antle	<b>11:35</b>	Multiple agendas and cultures in a participatory development of computerised IA tools - The experience of SEAMLESS Ann-Katrin Bäcklund
<b>11:55</b>	Reactions of the FSSIM stand-alone model to policy changes on the example of Zachodniopomorskie Nuts2 region Edward Majewski	<b>11:55</b>	Better regulation by the use of integrated assessment? SEAMLESS Integrated Framework and European policy-making Robert Fischer
<b>12:15</b>	Assessing the sustainability of Irish agriculture Emma Dillon	<b>12:15</b>	Integrated impact assessment as a new institution. The political dimensions of modelling-tool use Martina Padmanabhan
<b>12:35</b>	Alpine grazing trends in Switzerland: Economic importance and impact on biotic communities Gabriele Mack	<b>12:35</b>	Posters
<b>12:55</b>	Discussion	<b>12:45</b>	Discussion



**Slot 12: Thursday 14:00-15:30**

**Zuiderduinzaal**

**Plenary session**

Chair: Ken Giller (Wageningen University)

**AgSAP poster award**

**Forum discussion to:**

- Present the key scientific achievements from the conference
  - Identify the scientific challenges ahead
- Identify policy advice for impact assessment of agriculture and sustainable development, and
  - Strengthen science-policy interactions in agriculture and sustainable development

**Closing**

## **Information for presenters during AgSAP**

### Oral presentations:

Presentation time 15 min plus 5 min for questions.

Please bring your presentation (PPT, max. 15 slides) on a stick and paste your presentation on the PC in the lecture room at least one hour before your session starts.

Introduce yourself to the chairperson of the session, so that he/she knows you are present.

### Poster presentations:

Poster may be set-up on Monday evening during the welcome reception or on Tuesday morning. Please hang them on the poster wall with the number corresponding with the poster number in the programme book (pages 29-35). The posters are grouped by session.

Posters shall be on display until Thursday evening.

A good layout and design of your poster, and of course scientific content will be rewarded in the poster prize nominations.

Criteria for the poster evaluation will be: quality of the research, clarity of the poster and presentation of the poster.

If you are requested to give a short (3 to 5 min.) presentation about your poster, please bring a short presentation (PPT, about 3 slides) on a stick and paste your presentation on the PC at least one hour before your session starts.

## Poster and demo contributions in alphabetic order per session (D = demo)

Session A-1		<b>Methods for integrated assessment of agricultural systems and land use</b> <i>Poster tour, slot 4, on Tuesday 16:00 – 17:00</i>
1	Arriaza, Manuel	Integrating social preference
2	Berkhoff, Karin	Understanding land use change with the aid of an integrated modeling framework - a case study on rural south-west China
3	Christen, Olaf	Concept and application of a DLG sustainability standard on the farm level
4	McRoberts, Neil	Construction of a multi-attribute model of arable system sustainability by elicitation of expert opinion
5	McRoberts, Niel	Gathering baseline data for studying arable system resilience in Scotland by integrated farm surveys
6	Santos, Rui	Framework for the socio-economic performance assessment of irrigation schemes
7	Spoelstra, Sierk	Sustainable livestock production: assessment of farmers initiatives
8	Wustenberghs, Hilde	Measuring sustainability at a supra-farm level: evaluation of methods

Session A-2		<b>Methods for up- and downscaling in integrated assessments</b> <i>Poster tour, slot 4, on Tuesday 16:00 – 17:00</i>
9	Britz, Wolfgang	Calibration of regional programming models to exogenous supply elasticities by a variable cost function- the CAPRI-EXPAMOD example
10	Elbersen, Berien	Compliance and costs of compliance: A procedure to obtain estimates at a disaggregated level
11	Rufino, Mariana	Competing use of organic resources and interactions at village scale in a communal area of NE Zimbabwe
12	Turpin, Nadine	PRIMA, Prototypical Policy Impacts on Multi-functional Activities in rural municipalities
13	Van Bussel, Lenny	Assessing the effects of data aggregation using a crop simulation model
14	Van de Giesen, Nick	Scale effects in Hortonian surface runoff with management implications
15	Zakayo, Samwel	Risk assessment methodology for pesticide control in the Nil River Basin, Belgium
16	Zasada, Ingo	A generic downscaling approach for scenario driven modelling outputs from European to regional scale

Session A-3		<b>Integrated assessment of ecosystem services from agriculture</b> <i>Poster tour, slot 4, on Tuesday 16:00 – 17:00</i>
17	Arriaza, Manuel	Restoration of abandoned agricultural lands toward umbrella species habitats
18	Blaeij, Arianne de	The monetary value of combining ecosystem-services in private artificial wetlands
19	Dirkx, Joep	Green services: bridging the gap between consumers and producers of landscape in the Netherlands?
20	Elbersen, Berien	Quantification of the relationship between changes in farming and changes in biological diversity: the Atlantic case
21	Giannoccaro, Giacomo	Integrated assessment of multi-functionality of irrigated agriculture: an application for the Mediterranean regions
22	Rudrum, Dale	Cost effectiveness of biodiversity in agricultural production systems
23	Stoorvogel, Jetse	A novel site-specific methodology to assess the supply curve of environmental services
24	Turpin, Nadine	Towards indicators of multi-functionality: assessing jointness between commodity and non-commodity outputs
25	Villa, Ferdinando	Understanding agricultural ecosystem services with ARIES (ARTificial Intelligence for Ecosystem Services)
26	Willemen, Louise	Translating spatial policy into future landscape functions

Session A-4		<b>The organization of tools for impact assessment; standards or diversity?</b> <i>Poster tour, slot 4, on Tuesday 16:00 – 17:00</i>
27	Fricke, Katharina	Choose complexity - how to bundle knowledge in Integrated Assessment Tools?
28	Khanh Hoang	Linking agricultural pollution to receiving waters using OpenMI
29	Turpin, Nadine	From models to indicators: ontologies as knowledge representation systems

Session B-1		<b>Large scale integrated policy assessment: tools and applications</b> <i>Poster tour, slot 4, on Tuesday 16:00 – 17:00</i>
30	Herrero, Mario	Incorporating livestock in global integrated assessments of land use and agro-ecosystems services
31	Müller, Marc	Comparison of econometric techniques for deriving consolidated databases: the AGROSAM case
32	Westhoek, Henk	Environmental impacts of the European livestock sector on different scales and prospects for reduction
33	Woltjer, Geert	Agricultural policy and land use

Session B-2		<b>Indicators for integrated assessment</b> <i>Poster tour, slot 4, on Tuesday 16:00 – 17:00</i>
34	Bockstaller, Christian	From a disaggregated set of indicators to a synthetic, composite assessment of sustainability: paths and pitfalls
35	Giannoccaro, Giacomo	Assessing the environmental sustainability of the CAP: a DPSIR framework approach
36	Meul, Marijke	Sustainability of Flemish farms: advising farmers and policy makers
37	Adamowicz, Mieczyslaw	Model and indicators of sustainable development in rural areas from the local perspective
38	Delmotte, Sylvestre	Contextualization of on farm <i>ex-ante</i> evaluation of the sustainability of innovative cropping systems in viticulture, using a multiple criteria assessment tool (DEXi)

Session B-3		<b>Cropping system modeling</b> <i>Poster tour, slot 4, on Tuesday 16:00 – 17:00</i>
39	Adam, Myriam	APES, an agricultural production and externalities simulator evaluated for two main crops in Midi-Pyrenees
40	Belhouchette, Hatem	Performances of two crop models in various conditions : the importance of the assumptions behind
41	Casellas, Eric	A methodology for the evaluation and improvement of a generic biophysical soil-plant-atmosphere crop model based on "Mini-Application"
42	Erdélyi, Éva	The effects of climate change on the phenology of cereal crops in Hungary
43	Fantke, Peter	Estimating external costs from the application of plant protection products in Europe
44	Guillaume, Solenne	Modelling water and nitrogen interactions in durum wheat: a first step towards the conception of joint management strategies of irrigation and nitrogen fertilization
45	Heinemann, Alexandre Bryan	Optimization of upland rice breeding program based on crop modeling approach
46	Launay, Marie	A modeling approach to optimize the management of pea-barley intercropping in Europe
47	Lebonvallet, Sophie	Establishment of quinoa ( <i>Chenopodium quinoa</i> Willd.) and simulation of its culture on Bolivian Altiplano with the model of culture STICS
48	Mérot, Anne	An integrative modelling to simulate the agricultural system through a combination of a decisional, technical and biophysical sub-systems
49	Mirsky, Steven	A systems approach to optimizing agronomic and environmental performance of legume-based organic field corn production
50	Schönhart, Martin	Crop rotation modelling for integrated environmental assessment - case study results and empirical evidence
51	Snow, Val	Implications of heterogeneous urinary-N return for modelling pasture production and N losses from grazed pastures under climate change

52	Van der Velde, Marijn	The effect of conservation agriculture practices in Europe
----	-----------------------	--

Session B-4		<b>Bio-economic farm modeling</b> <i>Poster tour, slot 4, on Tuesday 16:00 – 17:00</i>
53	Ali, M. Akkas	Intervention of integrated home garden model for food security, nutrition and poverty alleviation
54	Lauwers, Ludwig	Using time driven activity-based costing data for modeling complex innovations: the case of batch farrowing
55	Reynaud, Arnaud & Mosnier, Claire	A dynamic bio-economic model to simulate optimal adjustments of suckler cow farm management to production and markets shocks
56	Ridier, Aude & El Ghali, Mohamed	Economic impact of voluntary agri-environmental measures: The case study of a "Test -Action" in a basin of south-western France
57	Salgado, Paulo	Adoption of new forage technology: impact on the socio-economic sustainability of milk production in Moc Chau, Vietnam (DAIVIE model)
58	Traore, Bouba	A bio-economic model to analyse the performance of the Cotton Sector in Mali
59	Van Meensel, Jef	Exploring production-theoretical insights for economic-environmental trade-off analysis

Session B-5		<b>Integrated assessment methods for regional and landscape levels</b> <i>Poster tour, slot 8, on Wednesday 12:15 – 13:45</i>
60	Bobojonov, Ihtiyor	Integrated assessment of crop and water allocation under conditions of uncertain water supply in the Khorezm region of Uzbekistan, Central Asia
D-1	Griffon, Sébastien & Auclair, Daniel	Visualizing changes in agricultural landscapes plus Demo on Seamless Landscape Explorer
61	Kros, Hans	Integrated analysis of the effects of agricultural management and spatial planning on environmental quality at landscape scale
62	Osterburg, Bernhard	Improving regional nitrogen balances
63	Shahbazi, Farzin	Assessing of sustainable agriculture development using MicroLEIS DSS in Souma area, Iran
64	Wagner, Susanne	Assessment of mitigation measures for air pollutants and greenhouse gases from agricultural systems in Germany at high spatial resolution
65	Warnecke, Sylvia	Regionally optimized animal farm manure transports in an area with high intensity animal farming systems

Session B-6		<b>Software infrastructures and tools for integrated assessments</b> <i>Poster tour, slot 8, on Wednesday 12:15 – 13:45</i>
D-2	Antle, John	The Tradeoff Analysis software: modeling tools to support informed policy decision making
66	Justes, Eric	OptimiSTICS, a software for STICS crop model parameter estimation and evaluation which was build up to function with other dynamical models
67	Kassahun, Ayalew	ProST - a process support tool for supporting water stress mitigation through a participatory approach
68	Knapen, Rob	Use of OpenMI in SEAMLESS
D-3	Meuter, Eelco	A graphical user interface for a generic bio-economic farm model (FSSIM)
69	Salazar, Osvaldo	An integrated framework for management of spatial and temporal data on a drained watershed
70	Steward, David	Groundwater concepts and agriculture: A GIScience data model study

Session C-1		<b>Integrated assessment of biomass for biofuel or renewables – trade-offs with feed and food</b> <i>Poster tour, slot 8, on Wednesday 12:15 – 13:45</i>
71	Bocardo, Paola	Life cycle assessment of the sugarcane production system in Brazil
72	Nonhebel, Sanderine	Energy from agricultural residues and the trade-off's to the food system
73	Schuler, Johannes	Assessing the environmental effects of an increasing biogas production on agricultural farms
74	Suuster, Elsa	Spatial assessment of abandoned agricultural land for bio-energy production
75	Thorburn, Peter	Enhancing the assessment of biofuels feedstock production through more realistic representation of farming systems
76	Van der Velde, Marijn	Water implications of biofuel crop cultivation and set-aside suspension in the European Union

Session C-2		<b>Modelling adaptation strategies to cope with climate change</b> <i>Poster tour, slot 8, on Wednesday 12:15 – 13:45</i>
77	Bezabij, Yisehak Gebregziabher	Assessment and predictions of agricultural drought for the Upper Blue Nile Basin, Ethiopia
78	Hachigonta, Sepo	Sensitivity of southern African maize yields to the definition of onset under conditions of climate change
79	Kan, Iddo	Impact assessment of climate change on vegetative agriculture: Discrete-choice analysis of land-use under partial equilibrium
80	Kim, Chang-Gil	Countermeasures of agricultural sector for Post-Kyoto protocol
81	Lieffering, Mark	Modelling the costs of climate change on grazing systems

82	Moriondo, Marco	Testing adaptation options in a +2°C warmer climate
83	Strauss, Franziska	Simulation of climate scenarios and the bio-economic assessment of different agricultural management systems in the Marchfeld region
84	Vigne, Mathieu	Energy use efficiency and greenhouse gases emissions of dairy farms of an isolated territory: case of Reunion Island from 2000 to 2007
85	Walker, Sue	Mujika community climate - cropping systems modelling exercise

Session C-3		<b>Application of integrated assessment tools</b> <i>Poster tour, slot 8, on Wednesday 12:15 – 13:45</i>
86	Amblard, Laurence	<i>Ex-ante</i> institutional compatibility assessment of policy options Insights from empirical applications and interactions with policy experts
87	Cacovean, Horea	Land-Use Management Using a Soil Survey Geographic Database for Viisoara-Aiton Hills (Transylvanian Plain-Romania)
88	Coletto, Lucia	Organic crop rotations evaluated using LCA (Life Cycle Assessment)
89	Onate, Juan	Assessing the effects of Cross Compliance obligations on European biodiversity and landscapes
90	Palma, Joao	Silvoarable agroforestry in Europe - systems for meeting food and industry crop requirements with improved resource-use efficiency
91	Sasaki, Hiroki	Integrated model of paddy rice production and related environmental effects

Session C-4		<b>Systems analysis informing policy – case studies from agricultural systems and rural regions in the face of change</b> <i>Poster tour, slot 8, on Wednesday 12:15 – 13:45</i>
92	Chen, Zhigang	Performance analysis on the changes of farmland property right system: an explanation of the diversification of Chinese farmland system in transition
93	Claeys, Dakerlia & Marchand, Fleur	Introducing flat rate direct payments taking into account social concerns and ecological non-commodities
94	Thorburn, Peter	Systems analysis underpinning development of management action targets to meet water quality objectives in sugarcane production systems



Session D-1		<b>Stakeholder involvement in designing, use and evaluation of integrated assessment models</b> <i>Poster tour, slot 8, on Wednesday 12:15 – 13:45</i>
95	Duru, Michel	Analysis of stakeholder - researcher interactions for designing a generic grassland model suited for a diversity of farmers' practices
96	Karadzic, Vanja	Transition towards more adaptive irrigation management: the impact of innovative technologies. A case study in Caia, Guadiana River Basin
97	Reidsma, Pytrik	SEAMLESS training material on concepts and models for Integrated Assessment of agriculture and sustainable development
98	Speelman, Erika	Understanding and modelling socio-ecological networks to support multi-scale governance of sustainable dairy farming systems
D-4	Speelman, Erika	Serious gaming as a tool to create sustainability awareness, discussion and negation among stakeholders in cattle systems, the case of Los Angelitos
99	Taverne, Marie	Specifying impact assessment simulations in interaction with end-users: the example of SEAMLESS-IF
100	Van Paassen, Annemarie	Using explorative models to enhance expert learning about farm context and farmer rationalities in Burkina Faso

Session D-2		<b>Role of integrated assessment for policy</b> <i>Poster tour, slot 8, on Wednesday 12:15 – 13:45</i>
101	Dahal, Binod Mani	Integrated assessment for the development of Progressive Coordinative Action (PCA) plan: an approach for sustainable agriculture
102	Hernández Jiménez, Veronica	Exploring receptivity through innovative actions
103	König, Hannes	Bridging the gap between science and decision makers for sustainable development of multi-functional land use in developing countries
104	Sieber, Stefan	Designing the development process of the meta-model Sustainability Impact Assessment Tools (SIAT)



## How to travel to hotel Zuiderduin

### From Schiphol airport by taxi:

For taking a taxi directly from Schiphol we recommend to make your reservations by e-mail (info@taxibaaij.nl) in advance with Taxi Baaij, providing the taxi company the details below. This company has agreed a fixed lower rate for a trip to Zuiderduin. If the driver can combine passengers from more arrivals (max waiting time 30 minutes) that will reduce your costs. Taxi Baaij will be waiting for you at the Meeting point at Schiphol, showing an announcement with hotel Zuiderduin and Taxi Baaij.

Costs of transport by taxi from Schiphol to hotel Zuiderduin: by car (max. 3 persons) € 76.00 per car, by mini bus (max. 7 persons) € 84.00 per mini bus. Payment should be done in cash.

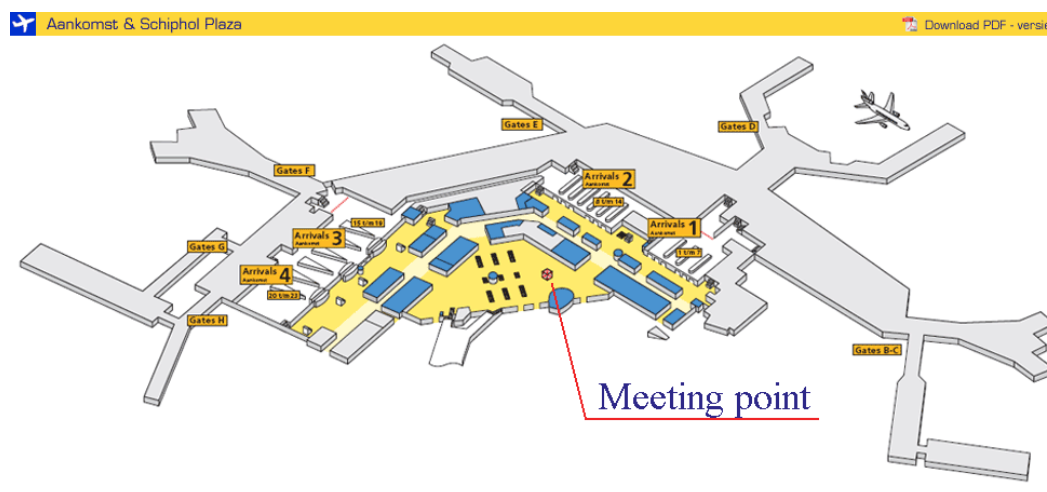

If you do not make use of the pre-reservation with Taxi Baaij, please keep in mind there are some less trustworthy companies driving cabs from Schiphol that ask very high prices and you also miss the contract prices made up between Hotel Zuiderduin and Taxi Baaij: **you should best agree on a price in advance**: it should not cost more than € 100.00 per taxi.

### From Schiphol Airport by train/bus/taxi:

At Schiphol railway station buy a train ticket to Heiloo (€ 7.70 in cash money or Maestro card) before boarding (otherwise you will be charged a fine on top of the fare). Take the train in the direction Hoorn (every half hour xx:12 and xx:42 from track 3), change trains at Zaandam (after 21 minutes) and cross the platform from track 1 to 2. Take the train in the direction Alkmaar and dismount at Heiloo station (after 19 minutes). From there you can take the bus, or Taxi Baaij (see next section). Please keep in mind that due to the small size of the village and railway station there is no taxi waiting for passengers. Please make your reservation, by e-mail, in advance giving the details below.

Costs for travelling by taxi from Heiloo station to Hotel Zuiderduin: by car (max. 3 persons) € 16.00 per car, by mini bus (max. 7 persons) € 22.00 per mini bus. Payment should be made in cash.

Details requested by Taxi Baaij (info@taxibaaij.nl)

Company						
First name	Last name	No. of pers.	GSM	time	flight	From
Date						

**By bus or taxi from Heiloo railway station:**

Bus (once or twice per hour, see schedule below): outside Heiloo train station take bus 164 in the direction Castricum, and leave the bus at the bus station in Egmond aan Zee (about 14 minutes). From there it is a 4 minutes walk to the hotel.

Taxi: at Heiloo train station, if you made a reservation with Taxi Baaij, find the taxi at the Stationsweg, west of the railway station.

If you made no advance reservation you can phone Taxi Baaij (+31 72 507 1328) or the OV-taxi +31 (0)900-8734682 (€ 0.35 per minute). OV-taxi ticket price is about € 12.00. Reservations are to be made at least half an hour in advance and preferably as early as possible as otherwise the waiting time can increase considerably. Address of Hotel Zuiderduin is Zeeweg 52, Egmond aan Zee.

Bus 164 direction Castricum: departure times from Heiloo railway station, leave the bus at the busstation in Egmond aan Zee.

8:17							14:17	15:17	16:17	17:17	18:17				
8:47	9:47	10:47	11:47	12:47	13:47	14:47	15:47	16:47	17:47	18:47	19:47	20:47	21:47	22:47	

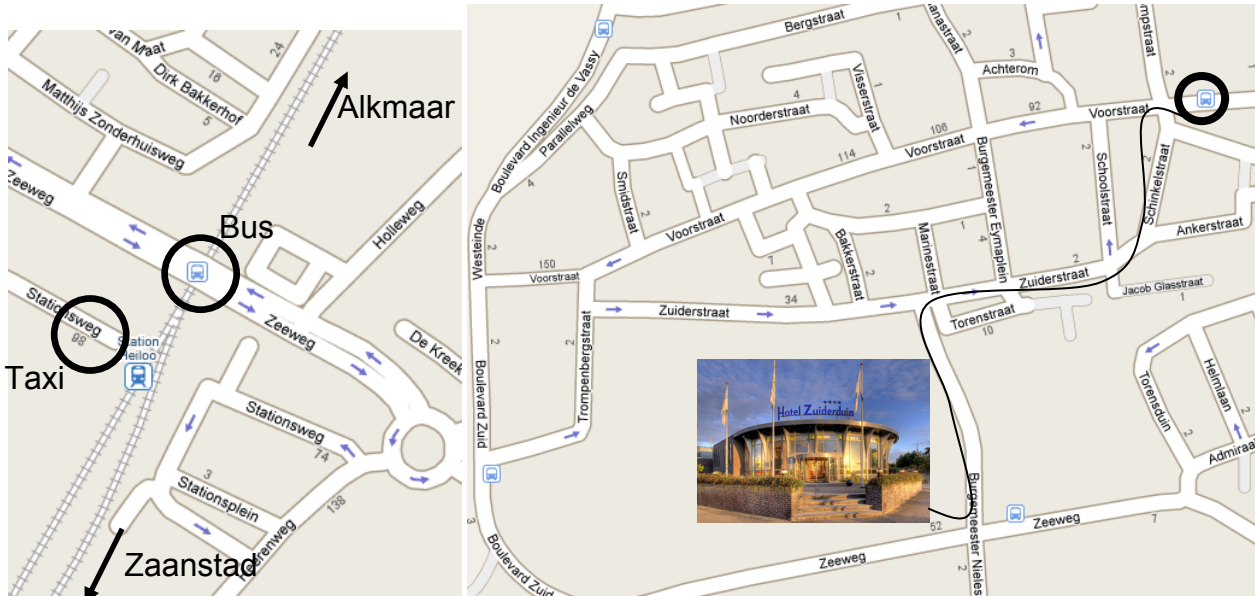

Heiloo railway station area

Egmond aan Zee: walk from bus station to the hotel

**By car:**

From Amsterdam on the motorway A9: at the Alkmaar roundabout take the Heiloo/Den Helder exit. You're now on the circular road. At the third traffic light turn left, exit Egmond. On this road please follow the signs Egmond aan Zee, look for more instructions at: "When arriving in Egmond aan Zee".

From Zaandam to Uitgeest: Use the motorway route N8 from Zaandam to Uitgeest. In Uitgeest leave the N8 and take the A9 towards Alkmaar (then follow instructions above).

When arriving in Egmond aan Zee: follow the road until T-junction and then follow the sign "Centrum". Here follow the sign "Strand-Zuid", this will lead to Admiraal de Ruyterweg. This road becomes, after a few curves, Zeeweg. The hotel and the parking (garage) can be found after 200 metres on your right at number 52.

**For checking travel info** please use the public transport sites: [www.9292ov.nl](http://www.9292ov.nl) & [www.ns.nl](http://www.ns.nl).

## **Departure**

On the day of departure you should check out at the hotel desk before 10.30 h. For luggage storage on your day of departure a room will be available near the session rooms and the conference secretariat.

When travelling to a European destination, you need to be at Schiphol airport 2 hours before the plane will leave.

When travelling to a non-European destination, you need to be at Schiphol airport 3 hours before the plane will leave.

### **By taxi:**

It will take a 45 minutes drive to the airport, or 15 minutes to the railway station at Heiloo if there is no traffic jam. Reservations for Taxi Baaij should be made in advance by e-mail as suggested above.

By bus and train: schedules will be available at our conference secretariat.

If you need our assistance with planning the trip back please consult us well in time.

## **Canal boat trip, city walk and dinner Wednesday 16:00-22:00**

The people who subscribed for the Canal boat trip, should after the short coffee break gather for the buses to Amsterdam.

As dinner will be fairly late (for Dutch standards), some snacks will be served during the coffee break.

In Amsterdam the bus will bring us near to the place where the boat trip will start (company “Holland International”). From here, a guided walking tour (17:30 until 18:30) is scheduled, in groups of about 25 persons, through a small part of the city. After that there is some time to visit the city on your own.

Please be back at the boats no later than 19:20. Make sure you take boat no. 1 in case you have indicated you have specific dietary requirements. Departure time for the “rondvaart” (canal cruise) is **19:30** sharp and the boats will not wait.

After the rondvaart, at about 22:00, the buses will pick you up and bring you back to hotel Zuiderduin. Please note that you may not be able to get back to the hotel the same evening if you miss the bus.

## Conference organization and supporting societies

### SEAMLESS project



SEAMLESS (System for Environmental and Agricultural Modelling; Linking European Science and Society) is an Integrated Project funded under FP6 of the European Union (2005-2009). It has developed a computerized and integrated framework to assess and compare alternative agricultural and environmental policy options. This work will be continued by the SEAMLESS Association.

The AgSAP conference has been initiated by the SEAMLESS project as its concluding event. SEAMLESS is run by a consortium of 30 research institutions and is coordinated by Wageningen University.

Contacting SEAMLESS: [seamless.office@wur.nl](mailto:seamless.office@wur.nl),  
[www.seamless-ip.org](http://www.seamless-ip.org) or [www.pps.wur.nl/UK/](http://www.pps.wur.nl/UK/)



### Endorsed by:

#### EFITA

Objectives: to facilitate the exchange and the development of knowledge and to stimulate the cooperation among national and international organizations and associations with interest in research on and application of information technology (ICT) in agriculture, food and the environment, to enhance the competitiveness of Europe and to promote the awareness of ICT in this domain.



Contacting EFITA: [webmaster@acta-informatique.fr](mailto:webmaster@acta-informatique.fr) or [www.efita.net](http://www.efita.net)

#### ESA (European Society of Agronomy)

Objectives: to promote the science of agronomy, to link those interested in agronomic research and development within Europe, and to promote a European Journal for Agronomy and a newsletter.



Contacting ESA: [esa@esagr.org](mailto:esa@esagr.org) or [www.esagr.org/structure/](http://www.esagr.org/structure/)

#### ICASA (International Consortium for Agricultural Systems Applications)

Objectives: to advance national and international agricultural systems research through the development and application of systems analysis tools and methodologies, and through the



development and use of crop simulation models because of their increasing importance in decision support systems at field, farm, watershed, regional and national scales.

Contacting ICASA: [icasa@icasa.net](mailto:icasa@icasa.net) or [www.icasa.net/](http://www.icasa.net/)

**IEMSSs (International Environmental Modelling and Software society)**



Objectives: to develop and use environmental modelling and software tools to advance the science and improve decision making with respect to natural resource and environmental issues, and to exchange information in the field of environmental modelling and software among physical, social and natural scientific and educational organizations, private enterprises as well as non-governmental organizations from different countries, including the promotion of the journal Environmental Modelling and Software.

Contacting IEMSSs: [www.iemss.org/society/](http://www.iemss.org/society/)

**European Commission**

Supports this conference through funding the SEAMLESS project.





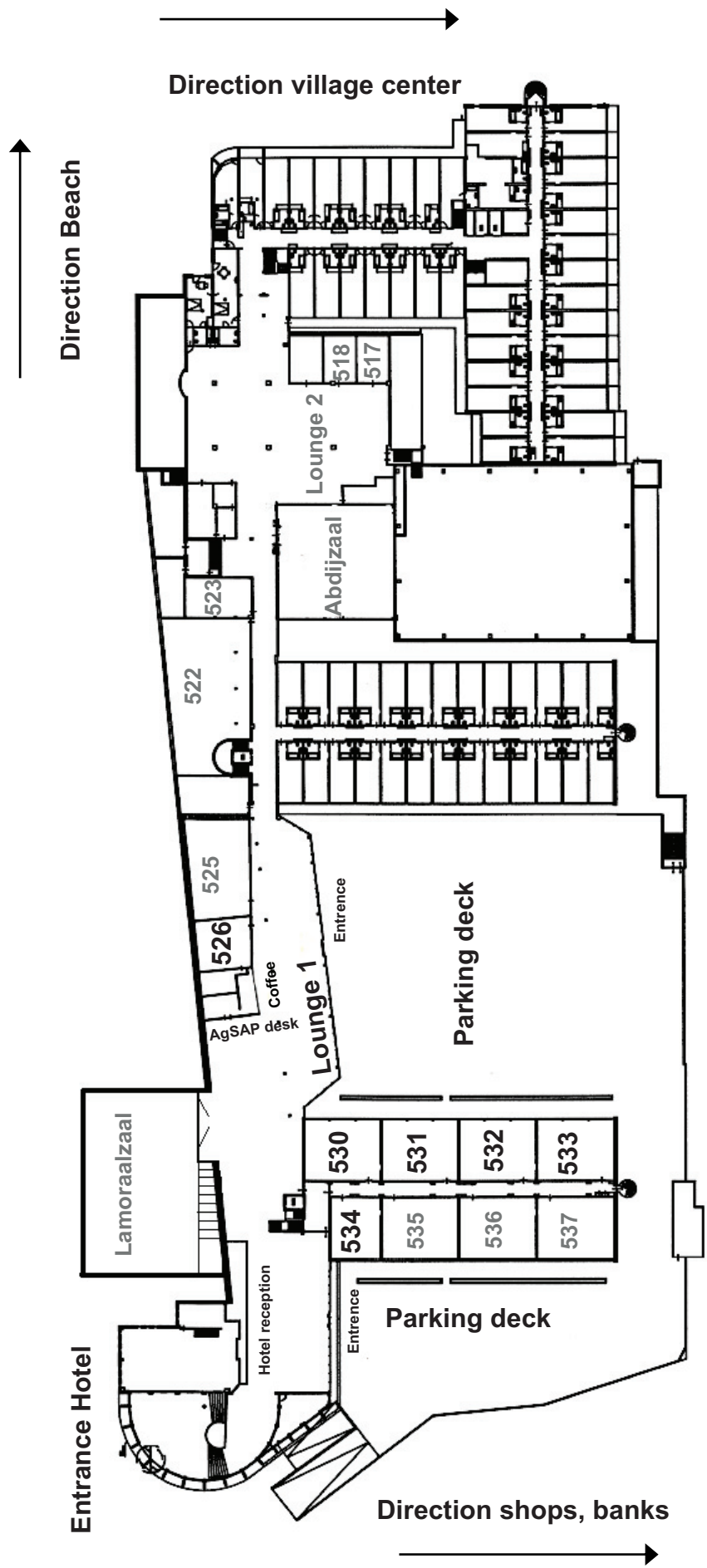

Direction Beach

Direction village center

Entrance Hotel

Lamoraalzaal

AgSAP desk

Coffee

Lounge 1

Entrance

522

523

Abdijzaal

Lounge 2

518

517

Parking deck

530

531

532

533

534

535

536

537

Parking deck

Entrance

Hotel reception

Direction shops, banks

First floor, entrance level

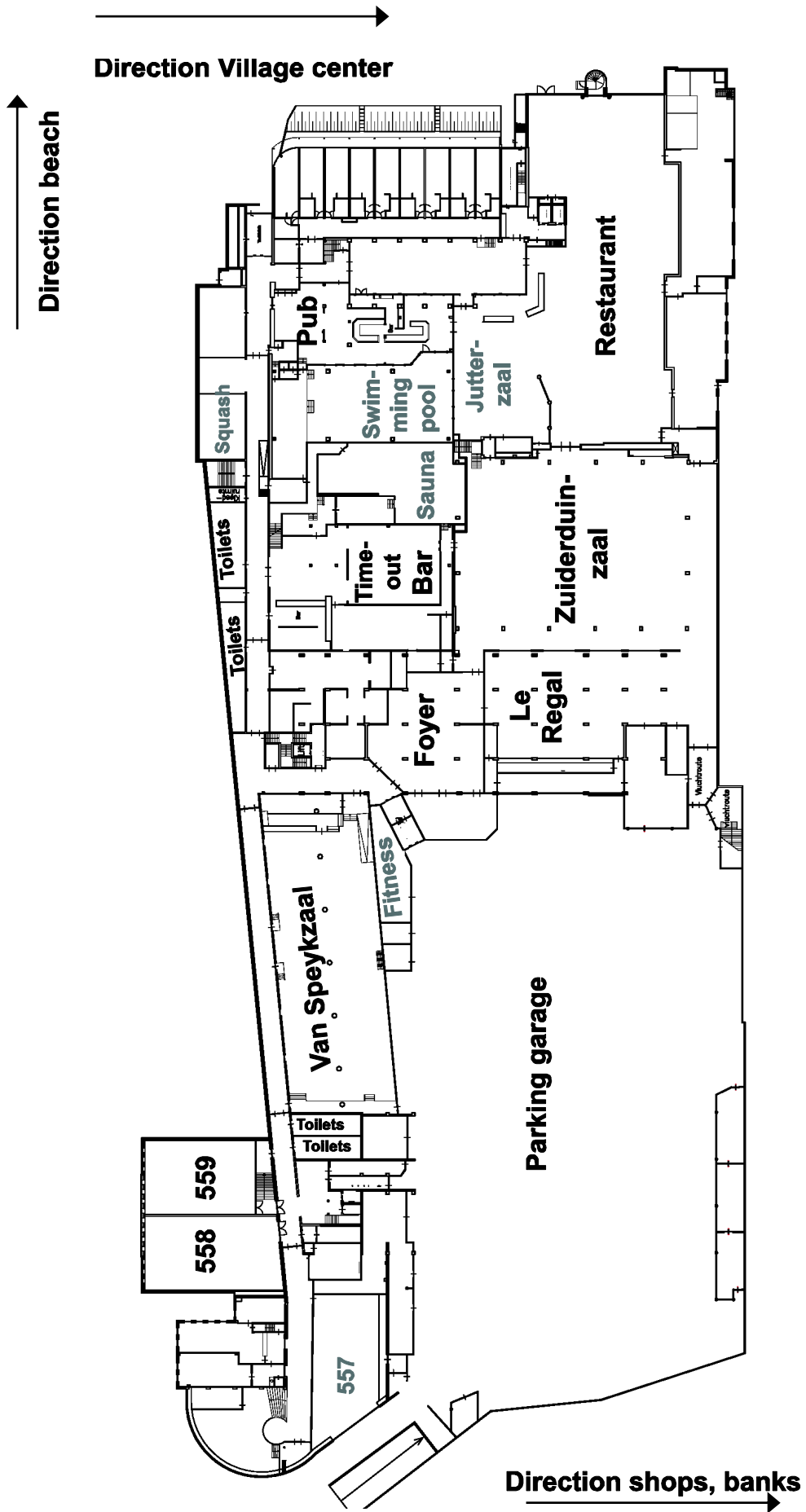

**Ground floor, Zuiderduinzaal level**

